

**Glucorx Safety Pen Needle**  
**Safety Pen needle for single use**  
**Instructions for use**

**1**

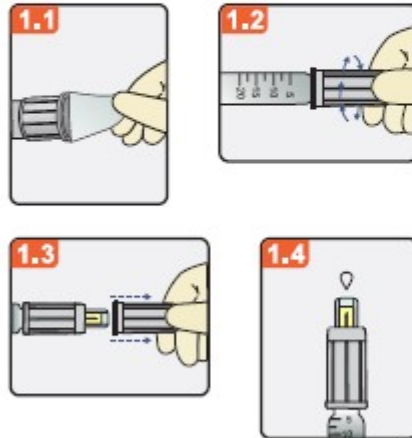

1. Attaching the needle to pen for injection
  - 1.1 Take off the peel tab off the safety needle.
  - 1.2 Holding the outer cover, push and screw the safety needle onto the pen in a clock wise direction until it meets the resistance.
  - 1.3 Pull only the outer cover straight off.
  - 1.4 Before injection, dial the dose on the pen for priming as per instruction of doctor or medical staff. Follow the instruction use of insulin pen, and check the flow in the safety needle by priming the device with an air shot,  
Note: A drop of liquid may fall back into the shield, which may result in excess fluid being left on the skin after injection.

**2**

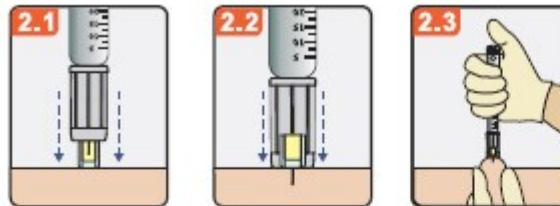

2. Performing the injection  
Dial the prescribed dose on the pen (per manufacturers instruction).  
Do not press the button during this step.  
Insert the needle into the skin at 90° angle and maintain it straight.  
To avoid injection in muscle, you may need to pinch the skin if needed, see figure 2.3.  
**Insert the needle straight into the skin in one continuous motion until the clear outer shield retracts and the white sleeve is flush with the skin. The safety mechanism is triggered at this moment. Refer to figures 2.1 and 2.2.**  
Maintain the constant pressure against the skin and deliver the dose by depressing the button, Hold the needle for 10 seconds before removing the needle until the dose has been completely delivered.  
( Warning: If the fluid drips out of the needle after it has been removed from the skin, leave the needle in place over 15 seconds after future injections to ensure that the dose is complete.)

**3**



3. Removing the safety needle
  - 3.1 Straightly lift the pen away from the skin. Inner shield will automatically deploy and lock in place. Color coded self-destructive hub becomes invisible.
  - 3.2 Unscrew the pen from the safety needle.
  - 3.3 Injection end is protected. Discard the used safety needle as per local safety regulation.

## GlucoRx Safety Pen Needles – User technique guide

### Insulin running down the side of patient after injection / the needle has not penetrated the skin

**Recommendation:** In line with your trust's guidance, we advise using the pinching technique with GlucoRx Safety Pen Needles. With regards to community members across your locality having difficulty injecting patients with a 'flabby abdomen', the pinching technique will enable you to apply enough pressure against the skin surface to activate the needle.



By using the pinching technique, you will be able to ensure/observe the white capsule flush against the patient's skin. The clear capsule should not be visible during injection. **Please ensure this step is completed successfully before administering the insulin dose.**

If this step is not completed correctly, there is potential for insulin to pool in the clear capsule and run down the side of the patient's skin when removed. If you are still unsure whether the safety needle has been activated, please check to see the yellow/blue cylinder which is only visible *before* injection (images below).

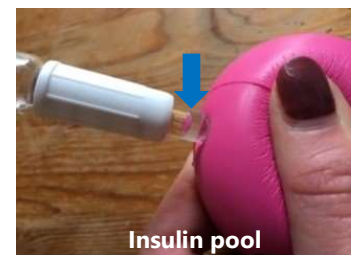

### There is insulin left in the capsule

**Recommendation:** In line with Injection Technique Matters (ITM) TREND guidance, please ensure you are holding the insulin pen straight upright for an air shot. Continue with 2 units of dose until insulin appears at the needle tip. Here there is a large possibility of insulin falling back into the transparent capsule; this is normal so please do not panic.

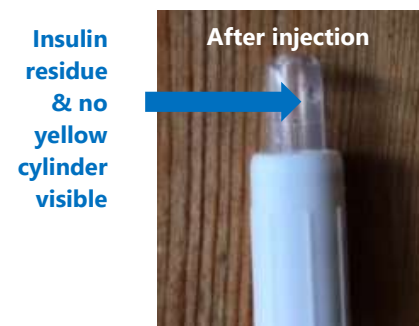
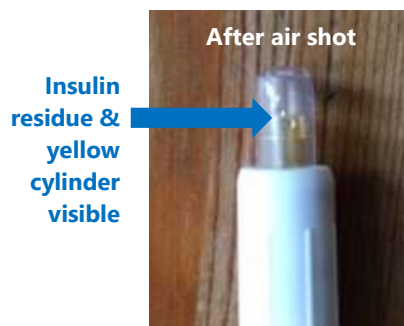
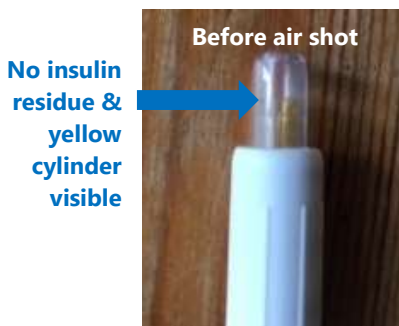

**There is insulin left on the patient's skin after injection**

**Recommendation:** We would expect a small amount of insulin to be left on the patient's skin after injecting. This is as a result of the insulin suck in the capsule after an air shot. To avoid under dosing, please ensure you are pausing for 10 seconds during dose administration.

**Insulin residue  
left on skin**



Please do not hesitate to contact GlucoRx if you have any questions using this product.

**GlucoRx Ltd**

Unit 1C, Henley Business Park, Pirbright Road, Guildford, Surrey, GU3 2DX.

☎ 01483 755133

✉ info@glucorx.co.uk

📄 01483 770195

🌐 www.glucorx.co.uk

Registered in England and Wales 07513682